

UM
MALE UNION

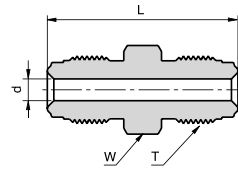

Ordering Information	Face Seal Size	L		d		W	T
	inch	mm	inch	mm	inch	inch	Thread Size
P-UM 1/4	1/4	39.4	1.55	4.6	0.18	5/8	9/16 - 18
P-UM 1/2	1/2	46.7	1.84	10.2	0.40	15/16	7/8 - 14
P-UM 3/4	3/4	62.0	2.44	15.8	0.62	1 5/16	1 1/4 - 18
P-UM 1	1	65.8	2.59	22.2	0.87	1 5/8	1 1/2 - 20

CM
**MALE TO MALE
NPT CONNECTOR**

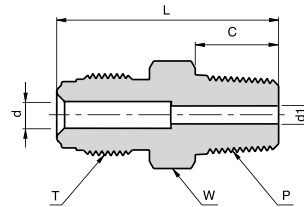

Ordering Information	Face Seal Size	L		C		d		d1		W	T	P
	inch	mm	inch	mm	inch	mm	inch	mm	inch	inch	Thread Size	NPT-M
P-CM-1/4 X 1/8	1/4	33.3	1.31	9.6	0.38	4.6	0.18	4.6	0.18	5/8	9/16 - 18	1/8
P-CM-1/4 X 1/4	1/4	37.8	1.49	14.2	0.56	4.6	0.18	4.6	0.18	5/8	9/16 - 18	1/4
P-CM-1/4 X R1/4 BSPT	1/4	37.8	1.49	14.2	0.56	4.6	0.18	4.6	0.18	5/8	9/16 - 18	1/4 BSPT
P-CM-1/2 X 1/4	1/2	41.9	1.65	14.2	0.56	10.2	0.40	7.1	0.28	15/16	7/8 - 14	1/4
P-CM-1/2 X 3/8	1/2	41.9	1.65	14.2	0.56	9.6	0.38	9.6	0.38	15/16	7/8 - 14	3/8
P-CM-1/2 X 1/2	1/2	46.7	1.84	19.0	0.75	10.2	0.40	10.2	0.40	15/16	7/8 - 14	1/2
P-CM-3/4 X 3/4	3/4	55.6	2.19	19.0	0.75	15.8	0.62	15.8	0.62	1 5/16	1 1/4 - 18	3/4
P-CM-1 X 1	1	62.7	2.47	23.9	0.94	22.2	0.87	22.2	0.87	1 5/8	1 1/2 - 20	1

Dimensions are for reference only, and are subject to change without notice.
When ordering, be sure to add the Surface-Finish Designator (either H or E) to the Part Number. (See Material Table, page 157).